

So simple.
Even in the dark.



found Evora Nasal simple
to put on and take
off in the dark.²



Find out more at www.fphcare.com/myevoranasal

Fitting summary

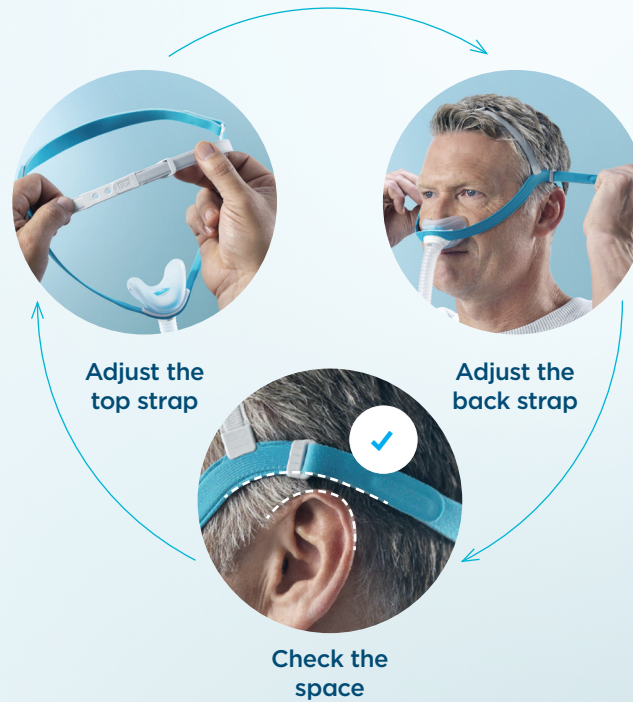

For further instructions, please refer to the Fitting Your Mask section of the Evora Nasal Use and Care Guide.

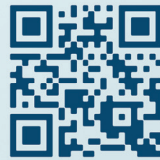

Find out more at
www.fphcare.com/myevoranasal

REF 619149 REV D © 2021 Fisher & Paykel Healthcare

1. Internal study of F&P Evora Nasal testing overall mask size against F&P Eson[®] 2. 2. 43 out of 44 trial participants were able to put on and take off the Evora Nasal mask once fitted, in the dark. Internal validation study conducted with 44 participants in the United States of America 2019.
*We refer to CPAP in this instance, but this may also include other positive airway pressure device modes such as APAP or Bilevel. Masks must be used with a PAP device to deliver therapy.
F&P, CapFit, Eson and Evora are trademarks of Fisher & Paykel Healthcare Limited.
For patent information, see www.fphcare.com/ip.
Prescription only. Use only as directed. Always follow the instructions for use. Your healthcare professional will advise you whether this product is suitable for you/your condition.

Fits like a cap



Introducing the world's first CapFit™ headgear

Starting anything new is a crucial time and learning to adjust to therapy is essential.

With the unique design of the F&P Evora™ Nasal CPAP® Mask, getting started with your mask is as easy as putting on a cap.



Freedom to move

The unique compact seal and flexible breathing tube keep the mask comfortably in place.



Minimal

With 64% less headgear contact on your face¹, the soft-knit contoured headgear delivers comfortable support.

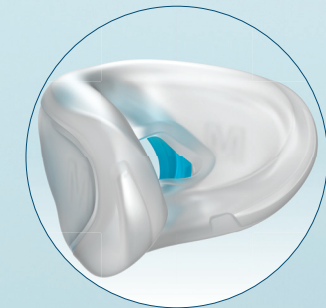

Comfortably compact

Sits comfortably under your nose to create a gentle fit.



Sleep quietly

Designed with exhaust holes that minimize noise and draft.